

# Tetra<sup>®</sup>test pH

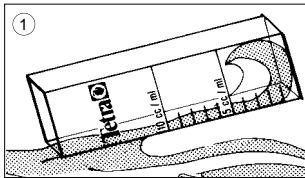

## Instruction leaflets

### Tetra<sup>®</sup>test pH

For an accurate measurement of the pH value of your aquarium water

**Important:** the Tetra<sup>®</sup>test pH freshwater is suitable for testing water from tropical and cold water aquariums or garden ponds.

Do not use the freshwater test kit for seawater as this leads to inaccurate results.

The Tetra<sup>®</sup>test pH seawater test is suitable for testing water from marine aquariums.

Do not use this for freshwater as this may also lead to inaccurate results.

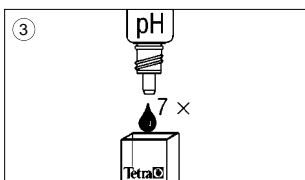
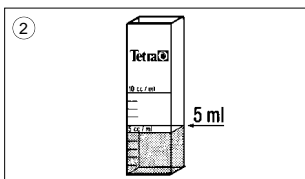

### Why test?

The pH value of water defines its acidity. Water with a pH value of 7.0 is regarded as neutral; below this value it is acid, above it is alkaline. For all freshwater organisms (fish, plants, microorganisms) a pH range between 6.5 to 8.5 is generally preferred.

In many areas tap water is likely to contain calcium carbonate and dissolved CO<sub>2</sub>. It is often slightly alkaline and has a pH range between 7.0 and 8.5. Water with a pH value that lies within a 6.5 and 8.5 pH range is normally suitable for tropical fish.

Marine fish require water with a pH value from 8.0 to 8.5.

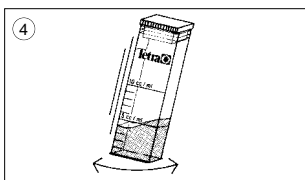

### How to test:

1. Rinse the test vial with the water to be tested
2. Fill the test vial to the 5ml (5 cc) mark with the water to be tested
3. Hold the liquid reagent bottle upside down and add 7 drops to the test vial
4. Shake the vial lightly

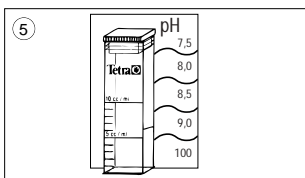

# Tetra<sup>®</sup> pH

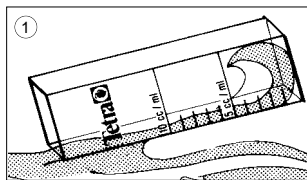

5. Hold vial and the color scale vertically and match the coloring of the test solution with the closest color on the color scale. Read the corresponding value. After each test, rinse vial thoroughly with tap water.

## After the test:

Should it be established during the pH test that the value lies below 6 or above 8.5, it is recommended to change one third of the water. A low pH value of the aquarium water can be obtained by filtration through peat. The pH value should not be changed suddenly. Always condition your clean replacement water with Tetra AquaSafe to neutralize any dissolved chlorine and heavy metals.

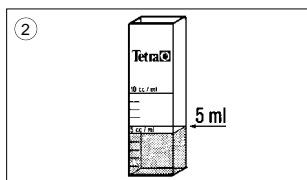

## Freshwater

WARNING - FLAMMABLE. EYE IRRITANT.

CONTAINS ISOPROPANOL.

WARNING

Do not use near heat or flame. Avoid contact with eyes. In case of eye contact, immediately flush with plenty of water. Seek medical attention if irritation persists. Use only in a well-ventilated area. Keep out of reach of children.

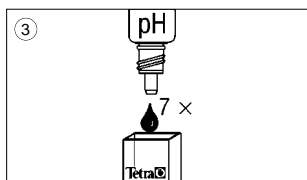

## Saltwater

WARNING - FLAMMABLE. EYE IRRITANT.

CONTAINS SODIUM HYDROXIDE (CAUSTIC SODA), PHENOLPHTALEIN AND ETHYL ALCOHOL (ETHANOL).

WARNING

Do not use near heat or flame. Avoid contact with eyes. In case of eye contact, immediately flush with plenty of water. Seek medical attention if irritation persists. Use only in a well-ventilated area. Keep out of reach of children.

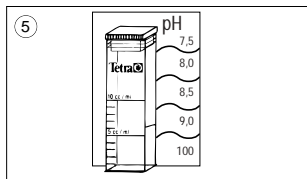
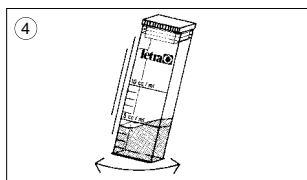

Art. Nr. 578289 USA - #4

For more information contact:  
Tetra Sales, USA  
3001 Commerce Street  
Blacksburg, VA 24060

TetraWerke  
Dr. rer. nat. Ulrich Baensch GmbH  
D-49304 Melle, Made in Germany

**Tetra**  <sup>®</sup>  
www.tetra-fish.com